

**MASER CONSULTING P.A.**  
Customer Loyalty through Client Satisfaction  
www.maserconsulting.com  
Engineers ■ Planners ■ Surveyors  
Landscape Architects ■ Environmental Scientists

Office Locations:

- Red Bank, NJ
- Clinton, NJ
- Hamilton, NJ
- Englewood, NJ
- Montvale, NJ
- Paterson, NJ
- Albany, NY
- New Windsor, NY
- Westchester, NY
- Charlotte, NC
- Raleigh, NC
- Lehigh Valley, PA
- Easton, PA
- Philadelphia, PA
- Pittsburgh, PA
- Orlando, FL
- Miami, FL
- Jacksonville, FL
- Sterling, VA
- Norfolk, VA
- Albuquerque, NM
- Columbia, MD

State of N.J. Certificate of Authorization: 24GA27986500

**811**  
Know what's below.  
Call before you dig.  
FOR STATE SPECIFIC DIRECT PHONE NUMBERS VISIT:  
WWW.CALL811.COM

REV	DATE	DESCRIPTION
1	7/8/2019	REVISED CONCEPT PER BOROUGH COMMENTS.

**CONCEPTUAL**

CONCEPT PLAN  
FOR  
MAIN STREET TAP  
GRANT - PHASE I

BOROUGH OF  
MANASQUAN  
MONMOUTH COUNTY  
NEW JERSEY

**RED BANK OFFICE**  
Corporate Headquarters  
331 Newman Springs Road  
Suite 203  
Red Bank, NJ 07701  
Phone: 732.383.1950  
Fax: 732.383.1984

SCALE: AS SHOWN	DATE: 8/21/18	DRAWN BY: SMW	CHECKED BY: RM
PROJECT NUMBER: MSQ554	DRAWING NAME: C-LAY1		

SHEET TITLE:  
**CONCEPT PLAN**

SHEET NUMBER:  
1 of 2

\*PARCELS SHOWN ARE FROM  
MONMOUTH COUNTY GIS  
DATABASE

30 0 30 60  
SCALE : 1" = 30'





# MAIN STREET TAP GRANT – CONCEPT PLAN

BOROUGH OF MANASQUAN, MONMOUTH COUNTY, NJ – JULY 2020





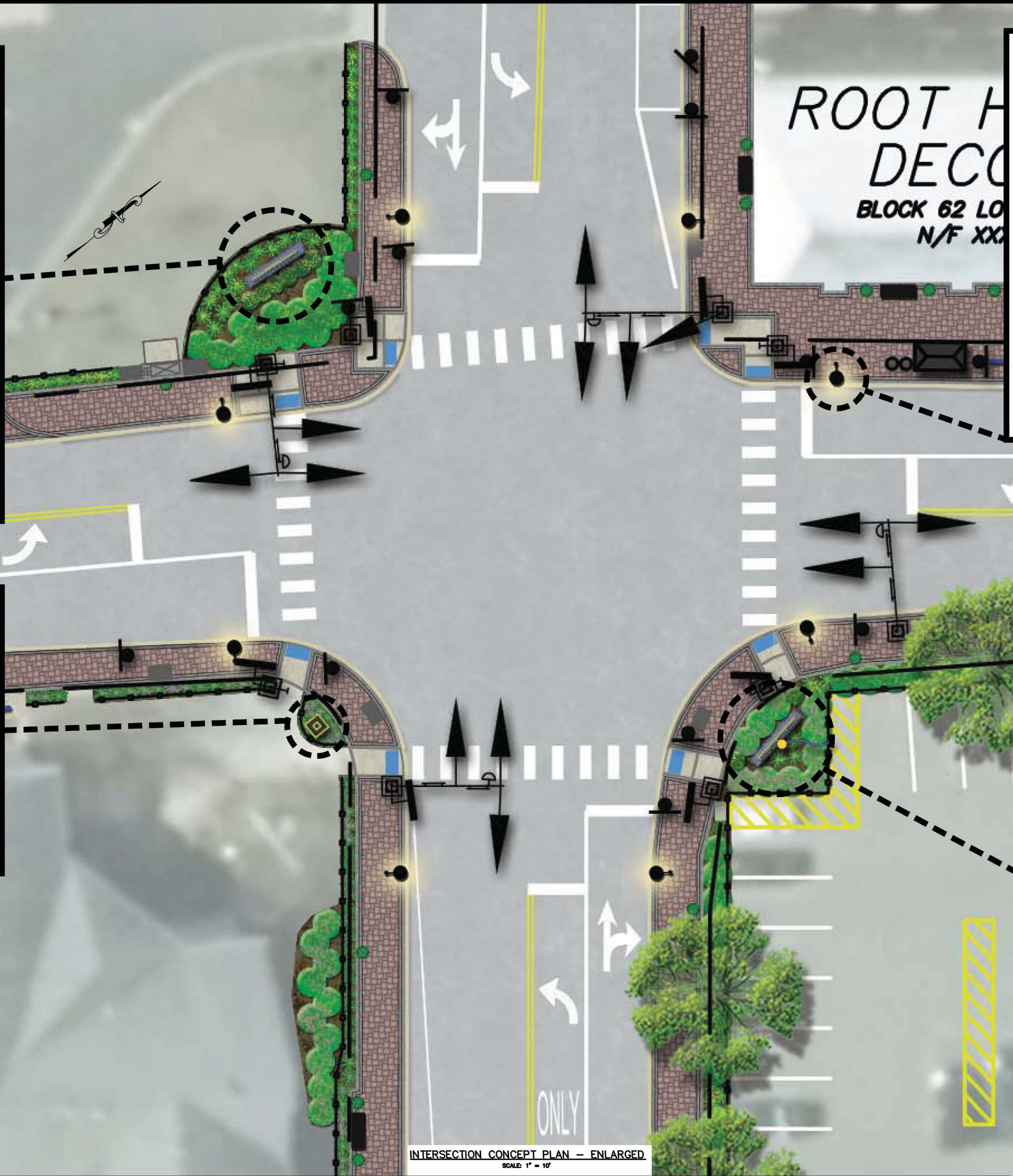
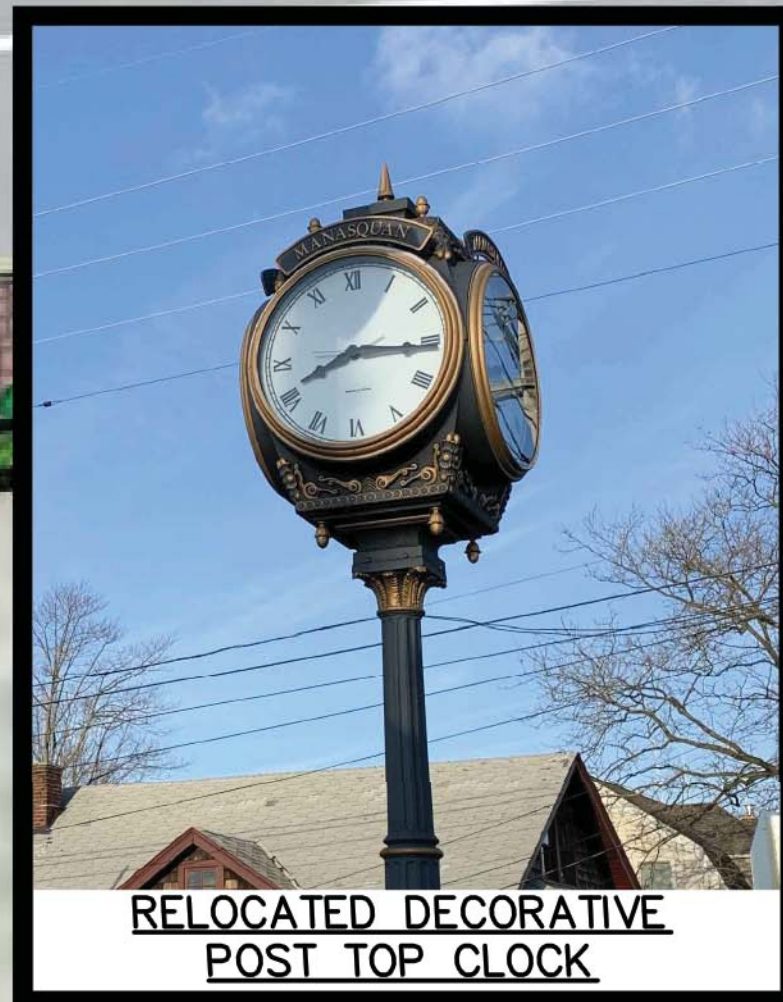
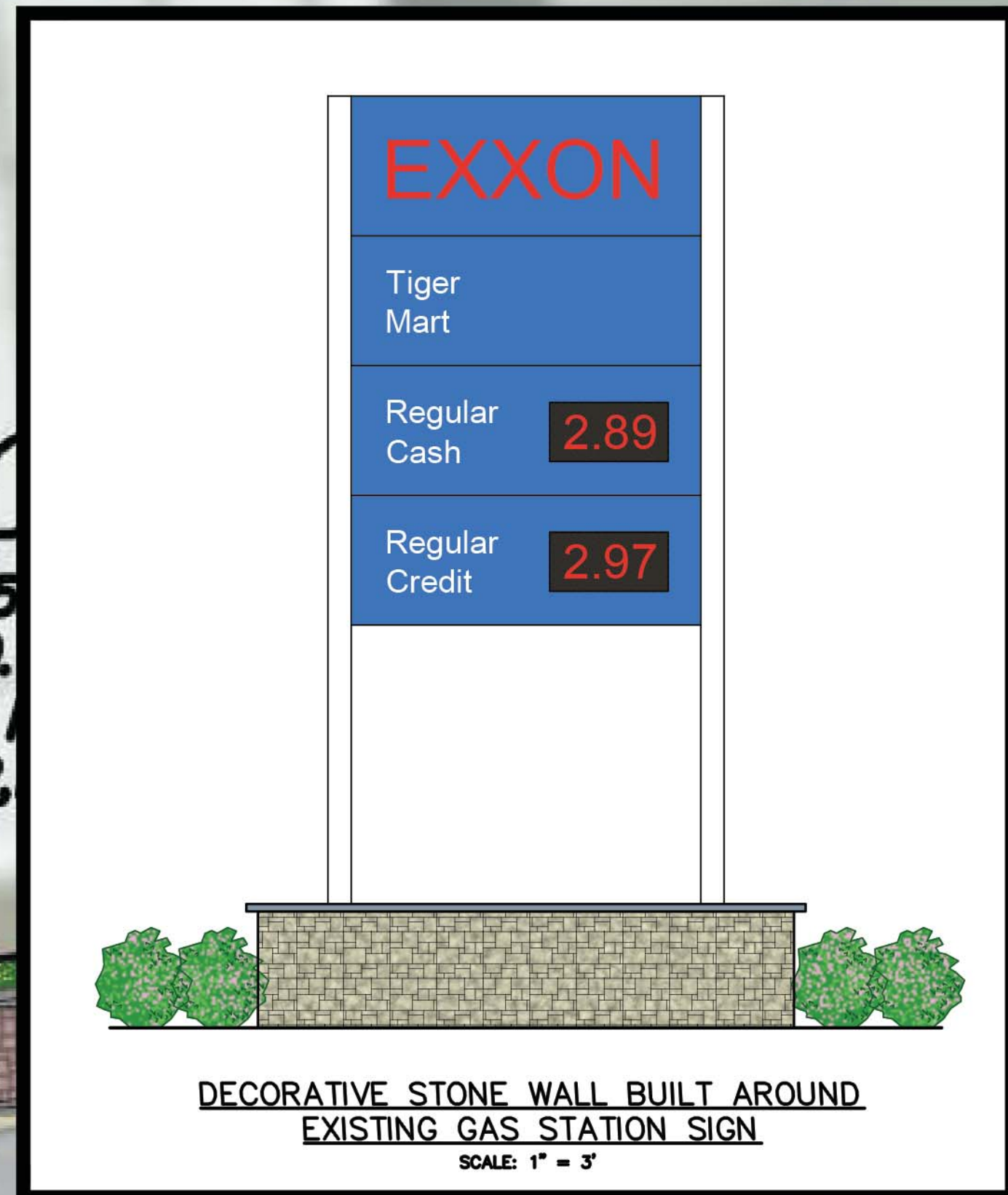

# MAIN STREET TAP GRANT — DETAIL CONCEPTS

BOROUGH OF MANASQUAN, MONMOUTH COUNTY, NJ — JULY 2020







OVERALL STREETScape LOOK



PAVING PATTERN  
(FROM ABE VOORHEES DRIVE)



DECORATIVE STONE WALLS FOR SIGNS  
(FROM ABE VOORHEES DRIVE)



DECORATIVE POST &  
CHAIN 'FENCE'



DECORATIVE PLANTER  
WITH ANNUALS



LIGHTING TO MATCH  
BOROUGH STANDARD



DECORATIVE BENCH

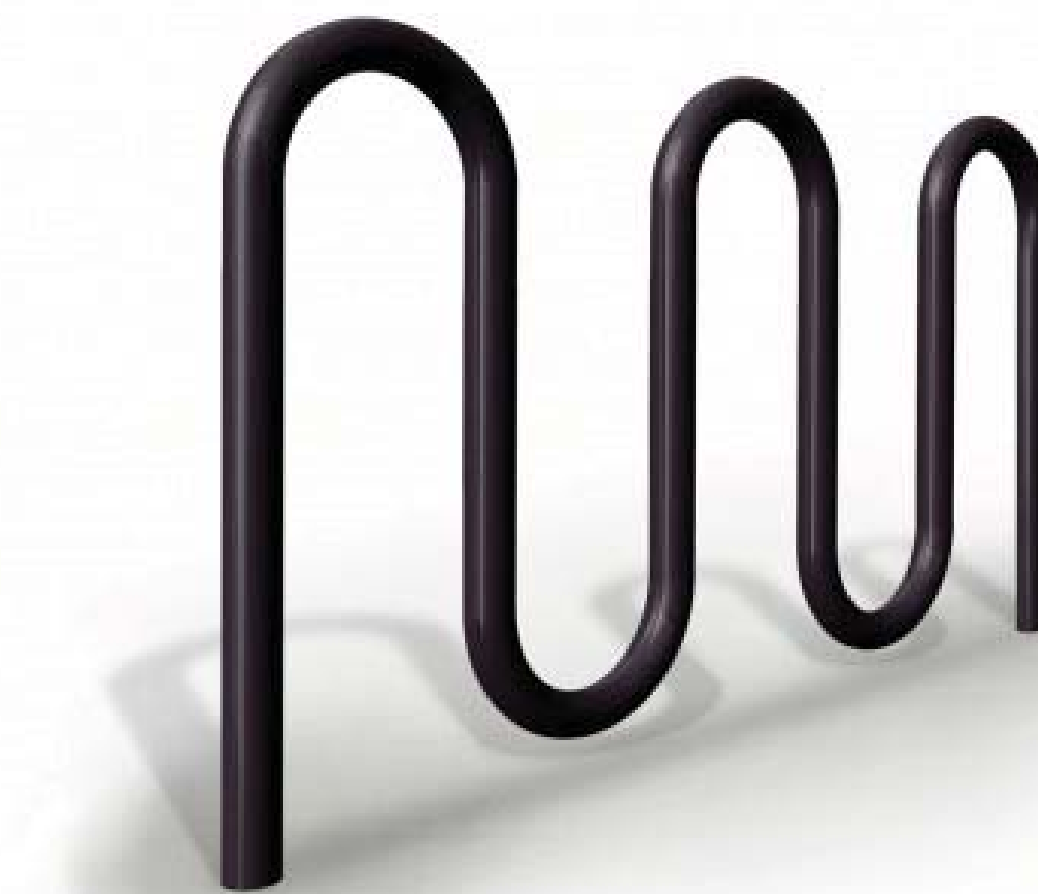

5 LOOP BIKE RACK



DECORATIVE TRASH &  
RECYCLING RECEPTACLES



# MAIN STREET TAP GRANT - INSPIRATION & EXAMPLES

BOROUGH OF MANASQUAN, MONMOUTH COUNTY, NJ - OCTOBER 2020





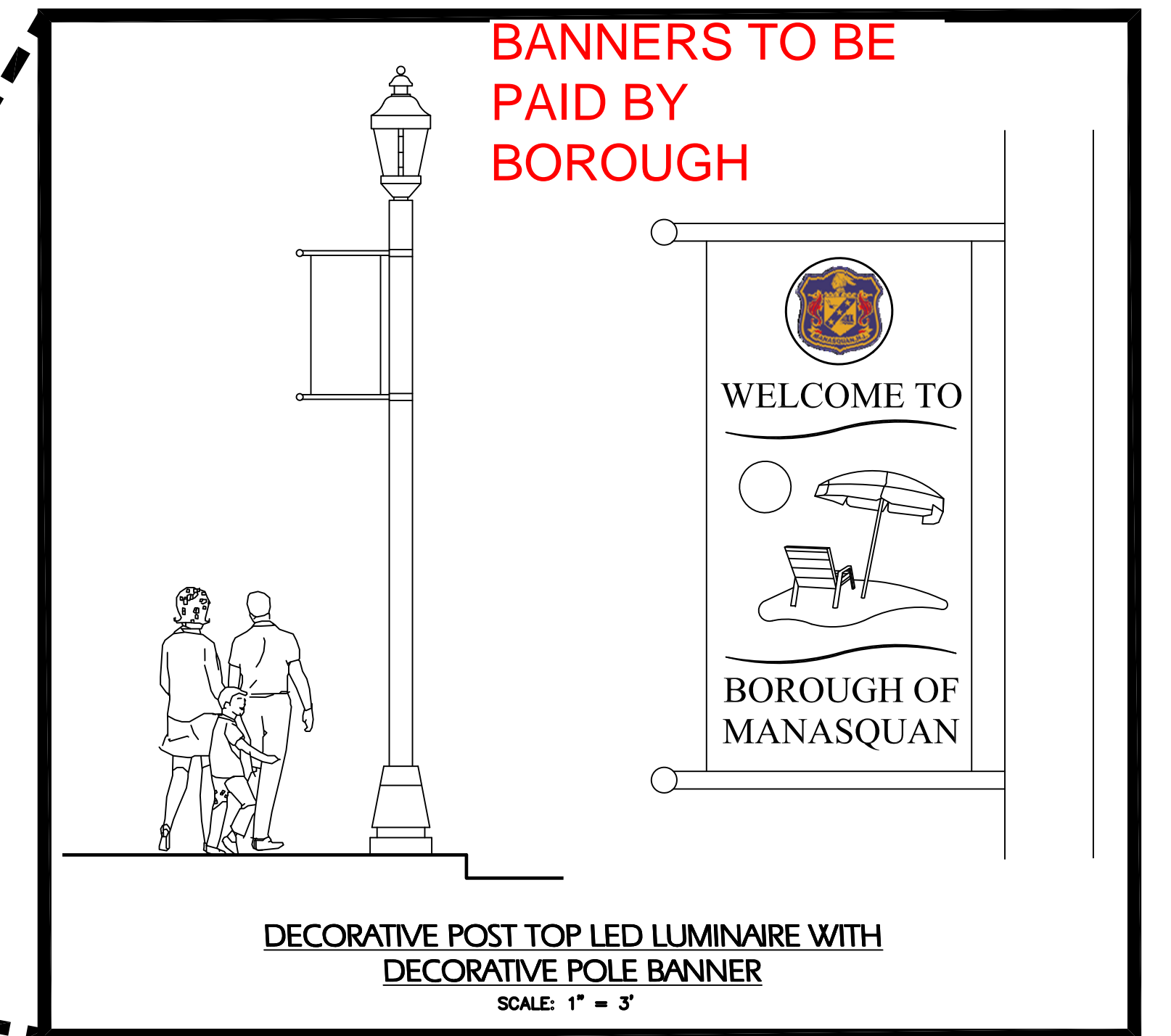
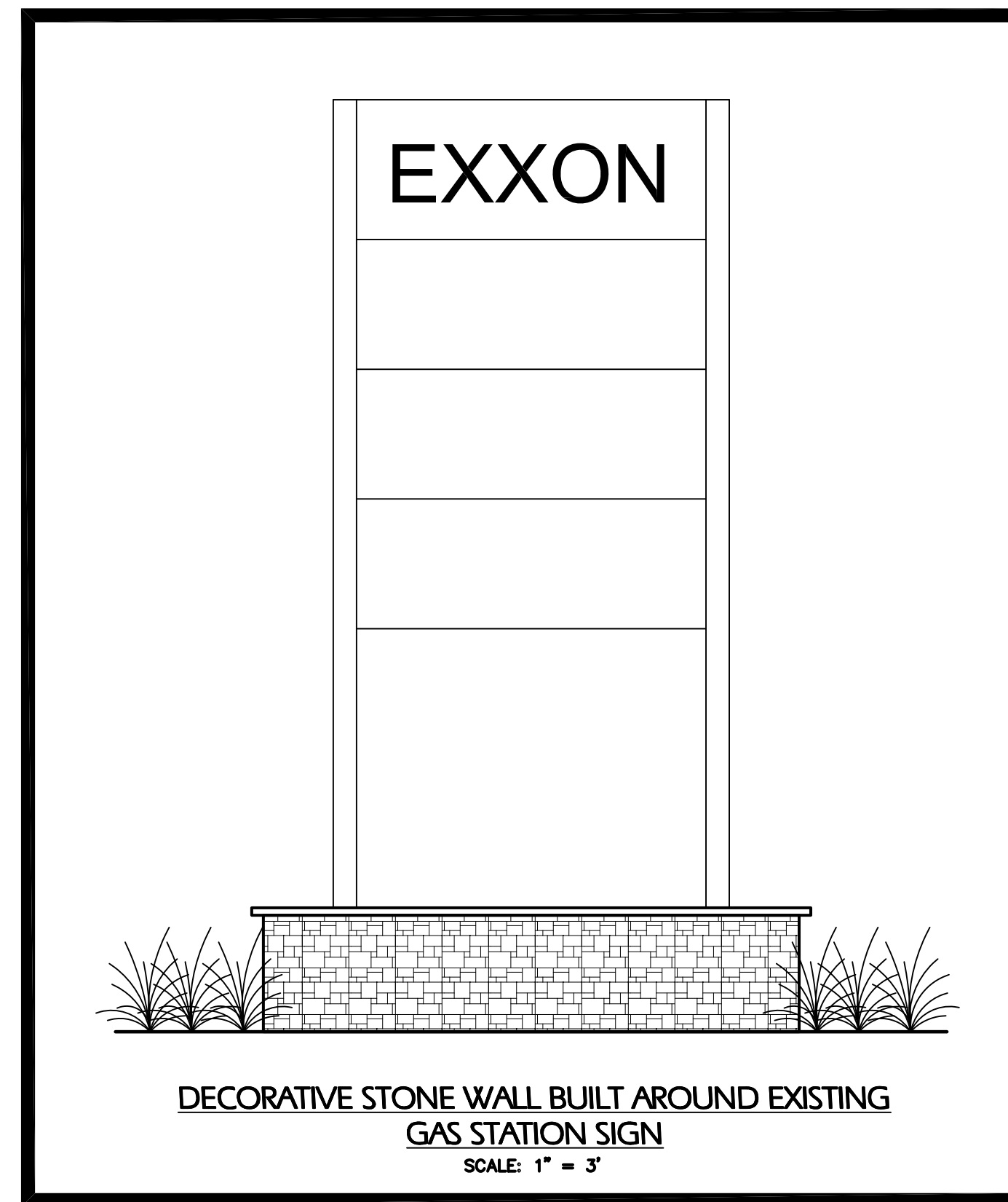

PROPOSED COURTYARD AREA TO BE PAID BY BOROUGH

FLAG POLE AND WELCOME SIGN TO BE PAID BY BOROUGH

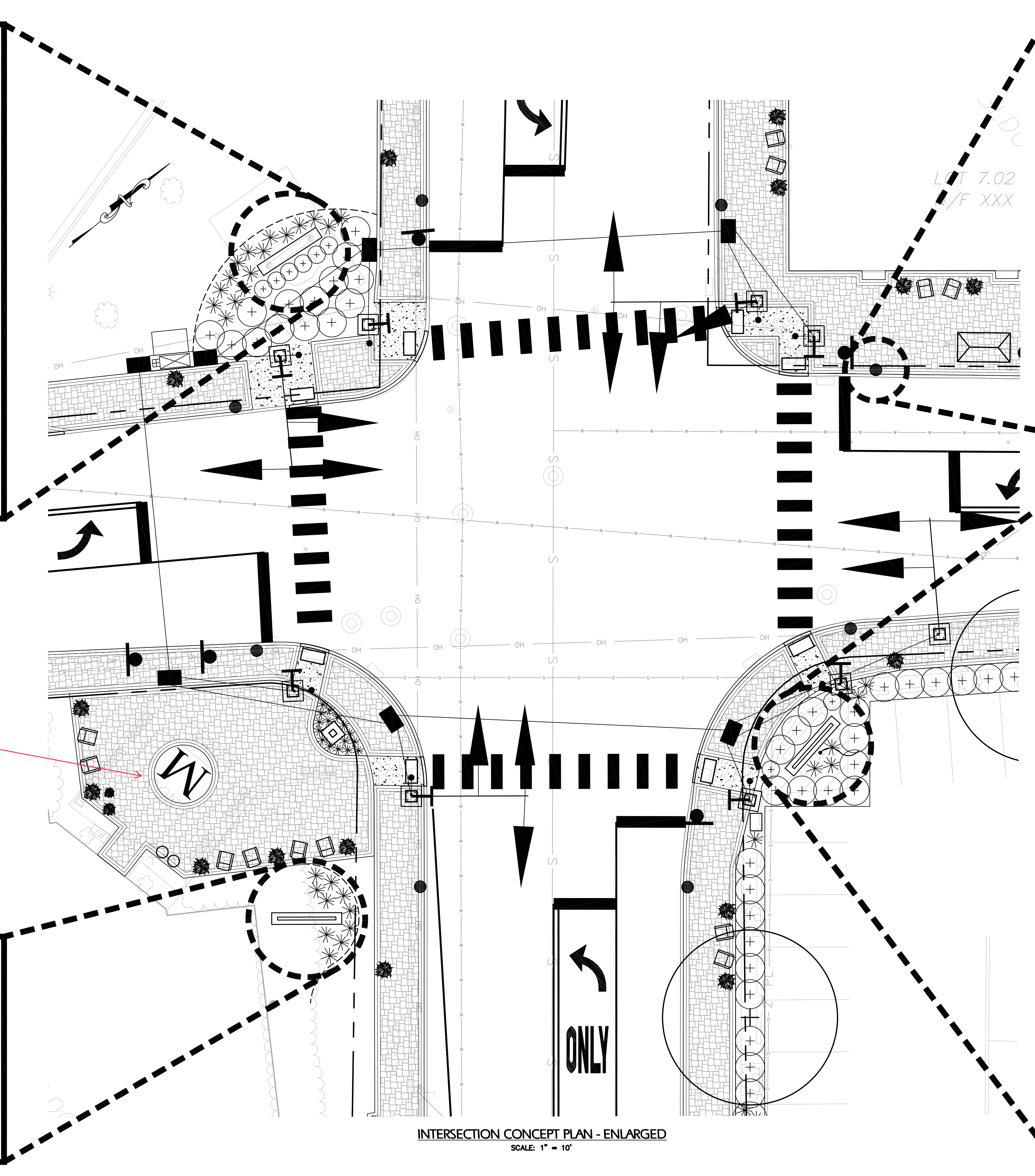

# MAIN STREET TAP GRANT - DETAIL CONCEPTS

BOROUGH OF MANASQUAN, MONMOUTH COUNTY, NJ – FEBRUARY 2020





**TAKE  
ONE**

# Gardener News

*Serving the Agricultural, Gardening and Landscaping Communities*

**TAKE  
ONE**

August 2018

GARDENERNEWS.COM

No. 184

## Beautifying Traffic Control Boxes with Spectacular Artwork



**By Tom Castronovo**  
Executive Editor

As a resident of Somerset County, N.J., I have been noticing agricultural, gardening and landscaping designs popping up in vehicle intersections, on traffic control boxes, for several years now.

One day I was sitting in my favorite coffee spot in Warren Township with my good friend Vic Sordillo, who happens to be the Mayor of Warren Township in Somerset County.

We were discussing environmentally friendly and beautification ideas for the township. During the beautification thoughts, the traffic control boxes came up.

Mayor Sordillo said, "The Somerset County Cultural & Heritage Commission (SCCHC) initiated a countywide public art project in 2010 entitled Gallery 24/7 to further integrate the arts into non-traditional venues." He also told me that it helps welcome tourism to Somerset County, and to Warren Township.

I really like the designs, especially the ones related to agriculture, gardening and landscaping. They really reflect the beauty of nature. And they sure look a lot better than a big silver-colored box (Cont. on Page 24)

Warren Township Mayor Vic Sordillo proudly looks over the Flowering Pink Rhododendron traffic control box that artist Vivian Bedoya designed. This traffic control box is at the intersection of Mountain Boulevard and Old Stirling Road in Warren Township.

Tom Castronovo/Photo



**PROTECT**  
your Summer flowers!

### NEW JERSEY DEER CONTROL®, LLC

Deer Repellent Specialists®

Monthly Spraying Service • All Natural Formula  
 Environmentally Safe • Harmless to Humans and Pets • Money Back Guarantee  
 Residential and Commercial • Owner Patented Product

**NOT AVAILABLE IN STORES!**

FREE ESTIMATES | [www.njdeercontrol.com](http://www.njdeercontrol.com) | (732) 995-7264



take back your yard!

**FREE SPRAYING!** with purchase of Initial Spraying (limited time offer)

"We've gone from having our 2 acres decimated by deer to having no problems whatsoever. This company stands behind its product & provides wonderful service. Worth every penny!" — Ernie J. Colts Neck



# Beautifying Traffic Control Boxes with Spectacular Artwork

(Continued from page 1)



Tom Castronovo/Photo  
**Horses Grazing** by artist Maia Reim. This traffic control box is at the intersection of South Finley Avenue and Cross Road in Bernards Township.



Tom Castronovo/Photo  
**Stone Planter** by artist Deborah Stair. This traffic control box is located at the intersection of Washington Valley Road and Promenade Boulevard in Warren Township.

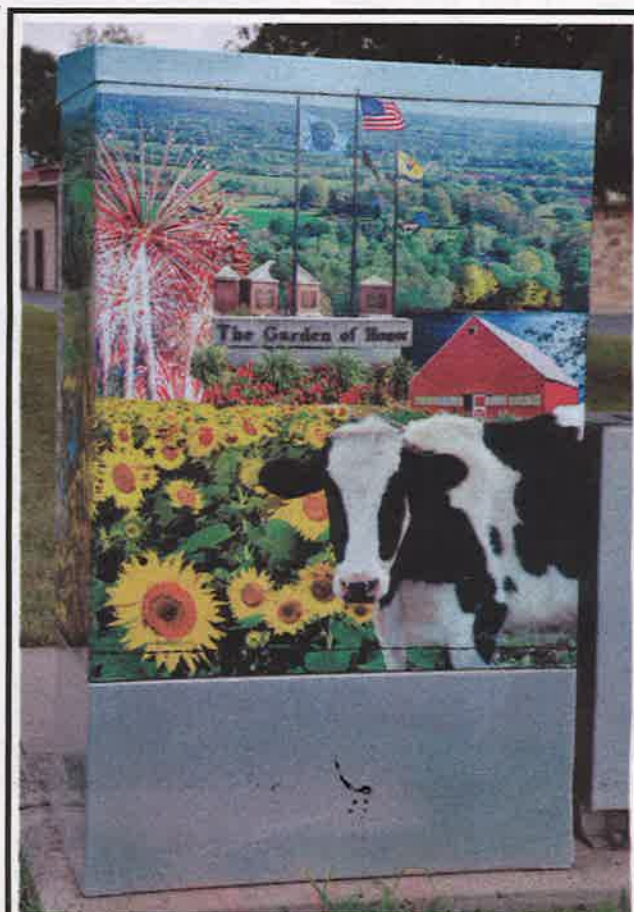

Tom Castronovo/Photo  
**Hillsborough Collage** by artist Walter Choroszewski. This traffic control box is located at the intersection of Amwell Road and Post Office Drive in Hillsborough.

on the side of the road. Some of the art-decorated boxes almost look like they blend right into the landscape. The friendly and eye-pleasing designs help soften the impact of an ugly utility box. They are truly a pleasant sight.

New Jersey is the Garden State. It is very fitting to see pictures of agriculture and horticulture being represented in our intersections to remind us of how beautiful the state is.

Some of the artwork on the boxes that impress me the most are the pink flowering rhododendrons, the horses, the cows and the rock gardens.

Several days later, I reached out to SCCHC and learned that this project has been made possible, in part, by the New Jersey State Council on the Arts (NJSCA), a partner agency of the National Endowment for the Arts, through the State/County Partnership

Local Arts Program Grant.

Funding for this grant comes from dedicated Hotel/Motel-Occupancy Tax via state legislation in 2003, which established a stable, renewable source for state funding of the arts, history and tourism. Cultural grants awarded by the NJSCA are supported by this revenue so the New Jersey taxpayer does not pay for public support of the arts through property, sales or income tax.

A total of 22 original artworks, selected between 2010-2012 through the well-publicized Call for NJ Artists, have been reproduced on a special vinyl adhesive film and professionally applied to the exterior of selected county-owned Traffic Control Boxes throughout Somerset County. A total of 28 boxes in the county now have artwork on them to date. Installation began in the fall of 2010.

Somerset County was the first county in the state

to initiate the art project. Since then, several other counties in the state have installed artwork on their traffic control boxes.

With the aid of dedicated funding provided by an arts grant, and through a competitive and professionally juried selection process, New Jersey visual artists were invited to create and submit original artwork for this project.

Mayor Sordillo also said, "In Warren Township, we have always been proud of our appearance and the quality of services and infrastructure. It is very rare to see property that is not well maintained or an eyesore within our neighborhoods. While we need to have utilities and the metal boxes that house the electrical components, we are very pleased to have worked with the county to beautify them with artwork of the colorful rhododendron flowers."

Warren Township has 19.3 square miles. It is nestled in the Watchung Mountains. Once described as "the greenest place in New Jersey," Warren Township residents and elected officials are working to keep its rural character and charm while recognizing that there will be growth due to the town's beauty, favorable property taxes and strategic location.

Somerset County is at the hub of Central New Jersey. Its 21 municipalities, which encompass 305 square miles, contain a diversity of landscape, population, and development that reflects the varied lifestyles of its estimated 333,751 residents.

As one of America's oldest counties, Somerset is steeped in colonial and Revolutionary War history. The county was established by charter on May 22, 1688, with land conveyances dating to 1651. Historic sites, monuments, and buildings are found in virtually every

town, preserved for future generations.

Thanks to some really great efforts and forward thinkers, this artwork no longer makes these aluminum boxes an eye sore or a target for graffiti and posters. I hope that someday all traffic control boxes have some form of artwork on them.

**Editor's Note:** Tom Castronovo is executive editor and publisher of *Gardener News*. Tom's lifelong interest in gardening and passion for agriculture, environmental stewardship, gardening and landscaping, led to the founding of the *Gardener News*, which germinated in April 2003 and continues to bloom today. He is also dedicated to providing inspiration, and education to the agricultural, gardening and landscaping communities through this newspaper and *GardenerNews.com*.























